



**Ebac Limited**

St Helen Trading Estate, Bishop Auckland, County Durham, DL14 9AL, United Kingdom

Tel: 0845 6349899 (GB)  
0800 638100 (F)  
0800 0229.229 (NL)  
00800 322.246.36 (B) (D) (A) (CH)  
+44 (0) 1388 605061 (ES) (IT)

Fax: +44 (0) 1388 609845

**[www.ebac.com](http://www.ebac.com)**



Where you see this symbol on any of our electrical products or packaging, it indicates that the relevant electrical products should not be disposed of as general household waste in Europe. To ensure the correct waste treatment of the product, please dispose of it in accordance with any applicable local laws or requirements for disposal of electrical and electronic equipment. In so doing, you will help to conserve natural resources and improve standards of environmental protection in treatment and disposal of electrical waste.



Made in Great Britain

# 6000 Series

# Introduction

The first time you plug in your new Ebac dehumidifier, you'll begin to realise the difference it will make to your home. You'll be amazed at just how much water this quiet, yet powerful unit extracts and stores in its container. It'll get you thinking where it all comes from and where it's been going all those years.

Incredibly, the average family produces 20 pints/12 litres of moisture a day. However, that's one fact you needn't worry about now.

Your Ebac dehumidifier is designed to cope with everything you do that adds even more moisture to the British climate. Everything from showering to washing up, boiling a kettle to breathing – they all add moisture to the air.

This brochure will help you get the very best out of your Ebac and not only protect your home from the damaging effects of condensation and damp, but also improve the quality of your air.

---

## It's surprising what an Ebac can do for your home

---

There's a lot more to your Ebac dehumidifier than preventing damp and condensation damage. It could actually improve your health.

Damp conditions provide the ideal breeding ground for dust mites. So, if you suffer from an allergy or asthma aggravated by dust mites, lower humidity levels may help. Also, sufferers of arthritis, bronchitis and rheumatism may also find relief from drier, warmer air.

Economy-wise, your Ebac dehumidifier costs typically 2p an hour to run. It can even lower your heating bills, as moist air absorbs heat. This is then removed and channelled back into the atmosphere to raise temperatures by up to 3°C. Plus, being light and portable, every room in the house can benefit too.



Made in Great Britain

Your Ebac dehumidifier has been specifically designed to cope with Britain's unique and unsettled climate by Europe's No.1 manufacturer of dehumidifiers.

---

## Important

---

Your Ebac 6000 is packed in a plastic wrapping, please ensure that it is disposed of safely and where it will not be a danger to children.

---

## Getting the most from your Ebac

---

1. Ensure it is always connected to the mains.
2. Ensure internal doors are kept ajar where possible to allow air circulation.
3. Ensure external doors and windows are kept closed as much as possible. This also saves wasting heat from your home.

---

## Getting the most from your Ebac

---

Moisture migrates around a home eventually condensing on the coldest surface. If the coldest surface is a window it will become coated in condensation. Cold walls may be affected by dampness and mould spots. Slightly cooler areas such as the hallway or landing are excellent positions for your dehumidifier. If possible leave interior doors partly open. If an area is particularly badly affected the dehumidifier can be placed in that room to concentrate the effect. DO NOT place next to a radiator or other heat source, as this will reduce the performance, the recommended distance from these is 2 meters.

---

## Positioning your Ebac 6000

---

1. Stand your Ebac 6000 upright for at least 2 hours
2. Connect the power lead
3. Plug in & switch on

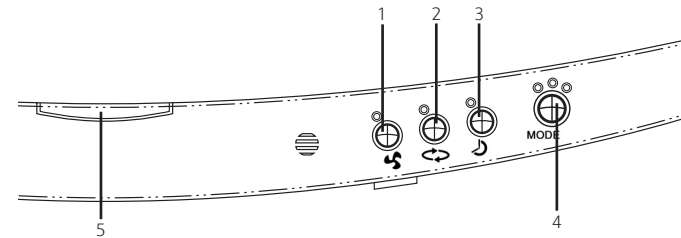

### CONTROL PANEL

1. Fan speed
2. Fan only / Air cleaning mode
3. Boost control
4. Smart control button & indicators
5. Blue = Power on indicator, Red = container full indicator, will flash red when nearly full

---

## Setting the controls

---

### Smart Control

Your Ebac 6000 is fitted with a unique patented intelligent control system which learns about your home and the weather conditions, the unit will then automatically decide when it needs to operate.

Smart control options.

1. Auto Economy (indicated by one green light illuminated)
2. Auto (indicated by two green lights illuminated)
3. Continuous (indicated by all three lights illuminated)
4. Off (no lights illuminated)

We recommend the unit be set to Auto for normal daily operation, however, there may be times when Continuous may be needed e.g. (1) when using a dehumidifier for the first time, (2) if conditions have worsened due to exceptional weather, or (3) where moisture generation in the home increases for a substantial period. Smart Control will normally adjust to points (2) and (3) however, you may wish to select Continuous to speed up the process.

Alternatively you may find that there are times when you can reduce the setting to Auto Economy which still works using Smart Control but at a reduced level, therefore running less often. Individual requirements will depend on individual circumstances.

---

## Setting the controls

---

### Boost Control

Ebac 6000 models have a boost control that increases performance of the unit in damp conditions. When activated this increases the fan speed and operating mode to maximum for eight hours. This is particularly useful for periods of high humidity such as drying laundry indoors or just after bathing. After this time the unit will return to the settings you had prior to activation.

### Fan only / Air cleaning mode

Ebac 6000 models are fitted with a fan only/air cleaning option. Select this mode if you want the fan to run all the time without the dehumidifier operating. This is particularly useful during the summer to provide a fan facility and for air filtration.

### Audible container full alarm

Your Ebac 6000 is fitted with an audible alarm which beeps approximately every minute once the container is full. This can be activated by pressing down the MODE button for 5 seconds until a beep is heard. You can de-activate this at any time by again pressing down the MODE button for 5 seconds until a beep is heard.

### Fan speed control

You may wish to change the fan speed of your Ebac from time to time. Using the Normal setting will remove more moisture from the air compared to the Quiet setting thereby improving efficiency. When switched on your dehumidifier will default to Normal.

Setting	Function
Light not illuminated	Normal setting
Light illuminated	Quiet setting

Your Ebac 6000 will collect excess moisture either as condensed water or ice on the heat exchanger located inside the unit. Any accumulation of ice is cleared periodically. Your Ebac 6000 incorporates a Defrost System which selects the correct defrost mode for your home. This maximises the efficiency of the unit at temperatures between 3°C / 37°F and 35°C / 95°F

---

## Emptying the water container

---

A red light on the control panel will illuminate when the container is full, an audible alarm will also sound (if activated). When this occurs water collection stops. When nearly full the indicator will flash a few hours before the container fills and again the audible alarm will sound. It is advisable to empty the water container if the unit will be unattended for more than a few hours to ensure the container doesn't become full and the unit switch off whilst you are away. Once full the unit will remain off until the container has been emptied and replaced.

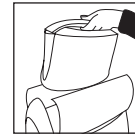

To empty, open the water container access door

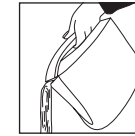

The container can then be removed and emptied as shown

Replace the container back into the dehumidifier with the outlet on the left hand side and gently close the access door. The dehumidifier will also switch itself off while the container is removed.

---

## Cleaning the filter

---

Your Ebac 6000 has a filter system to remove dust from the air. This requires cleaning and we recommend that the filter(s) be inspected every 4 weeks. Failure to do so will reduce the efficiency of your Ebac 6000. To clean, proceed as follows:

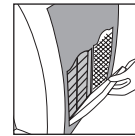

Remove the filter(s) by removing the filter covers

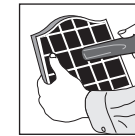

Remove the filter and clean with a vacuum cleaner on a low power.

To refit, place the filter material back into the holder(s) and replace onto the unit

To ensure continued performance from your Ebac 6000 the filter should be changed every 3 months.

---

## Re-locating your Dehumidifier

---

**NOTE:** The 6000 series has an internal reservoir which is periodically emptied into the removable container. If you plan to move the unit or switch off for a long period of time please do the following to empty the internal reservoir.

1. Switch the unit to the Off position. See 'Smart Control options'.
2. Wait for 1 minute to allow the pump to empty the internal tank.
3. Empty the removable water container.

A very small amount of water may remain inside which will normally evaporate naturally.

We therefore recommend that the unit be kept upright if moved soon after completing this procedure.

---

## Using the permanent draining facility

---

The Ebac 6000 range can be used in unattended dwellings such as holiday homes without emptying the water container. To use this facility you must order a permanent drainage kit using the accessory order form. Details of how to set up the drainage facility can be found in the drainage kit instructions.

---

## Caring for your Ebac 6000

---

Your Ebac 6000 requires very little maintenance, however, to maximise performance, inspect the filter every four weeks cleaning if required.

If your 6000 has a wood panel on the front this is real wood veneer. Due to the natural properties of wood the grain/pattern will vary from unit to unit. To clean the wood panel it is recommended that you clean it with warm soapy water.

Never use solvents or abrasive cleaners to clean your Ebac 6000.

Always check the following list before requesting service. Should a service call be requested and the fault be found to be detailed below, a charge may be made.

---

## If your Ebac 6000 fails to operate

---

**Power indicator light is not illuminated.**

Check

1. The unit is switched on at the mains. If necessary test the socket by plugging in another appliance.
2. Check the fuse in the plug and if necessary replace with another fuse, (5 amp) . If you continue to have problems please see 'Requesting Service'.

**Power indicator light is illuminated, but the unit is not collecting water.**

Check

1. The humidistat (if activated) may be set too low, increase the setting.
2. The water container may be full, empty the container.
3. The unit may have been set to standby mode – check the settings.
4. Ensure the water container is fitted. If you continue to have problems please see 'Requesting Service'.

**Fan Operates continuously.**

Check

1. Check that the continuous fan option is not selected. If you continue to have problems please see "Requesting Service".

**Reduced Water Extraction.**

Check

1. The smart control may be set at economy, if signs of condensation or dampness remain, increase the setting.
2. The filter may be blocked, remove, clean and refit.
3. After first being installed all dehumidifiers will collect less moisture as initial excess moisture is removed. This is normal.
4. The dehumidifier may be positioned next to a heat source i.e. a radiator - reposition. If you continue to have problems please see "Requesting Service".
5. Increase the fan speed which increases performance.
6. Outside temperatures have suddenly dropped in the past day or so. The dehumidifier may take a few days to get the problem back under control. If you continue to have a problem please see "Requesting Service".

---

## If your Ebac 6000 fails to operate

---

Dehumidifier collects water but it is not preventing condensation.

Check

1. The smart control may be set at economy, select the auto setting.

Red Water container light remains on all the time and the dehumidifier is not running (Normal when the container is full).

Check

1. Ensure the water container is empty.
2. Replace the water container and close the door slowly.
3. The light should now be out. If you continue to have problems see "Requesting Service".

---

## Technical and safety information

---

Min Operating Temperature	3°C
Max Operating Temperature	35°C
Fuse Rating	5A

NOTE: This unit also contains a 5\* 20mm ceramic fuse. Please contact your service number for further details.

- Appliance is suitable for indoor use only (excluding laundry rooms).
- Do not use the machine if the power cord or cabinet are damaged.
- If the flexible power cord is damaged it must be replaced by an identical cord which is available from Ebac Limited or an Ebac authorised distributor.
- Do not poke objects into any grilles on the machine.
- This machine complies with EMC/RFI directive EN60555 (BS800).
- Ebac has a policy of constant development and, therefore, reserves the right to change specifications without prior notice.

For accessories such as the drainage kit, please see the order form enclosed or contact your local dealer.

---

## Requesting service

---

Before requesting a service call please read the section "If your Ebac 6000 fails to operate correctly" and follow any advice this offers. If after following this advice you still experience problems please obtain the following information then contact our customer service department on 01388 602751(UK only)

1. Model and serial numbers (located on a rating plate behind the water container).
2. Your Name, Address, Postcode and Telephone Number.
3. Where your dehumidifier was purchased.
4. Date of purchase.
5. If applicable, any valid guarantee extension.

In other countries please contact your national distributor or retailer.

For service or further information please contact your local Ebac office detailed below or contact your retailer:

### **Ebac Limited**

St Helen Trading Estate, Bishop Auckland, County Durham, DL14 9AL  
United Kingdom

Tel: 0845 6349899 (GB)  
0800 638100 (F)  
0800 0229.229 (NL)  
00800 322.246.36 (B) (D) (A) (CH)  
+44 (0) 1388 605061 (ES) (IT)

Fax: +44 (0) 1388 609845

**[www.ebac.com](http://www.ebac.com)**